

---

<b>Report To:</b>	<b>Policy &amp; Resources Executive Sub-Committee</b>	<b>Date:</b>	<b>7 April 2020</b>
<b>Report By:</b>	<b>Corporate Director Environment, Regeneration and Resources</b>	<b>Report No:</b>	<b>LP/041/20</b>
<b>Contact Officer:</b>	<b>Lindsay Carrick</b>	<b>Contact No:</b>	<b>01475 712114</b>
<b>Subject:</b>	<b>Proposed Traffic Regulation Order – The Inverclyde Council, Disabled Persons’ Parking Places (On-Street) Order No. 1 2020</b>		

---

## 1.0 PURPOSE

- 1.1 The purpose of this report is to request the Sub-Committee to consider a remit from the Environment & Regeneration Committee.

## 2.0 SUMMARY

- 2.1 The Environment & Regeneration Committee held on 5 March 2020 after consideration of a report by the Corporate Director Environment, Regeneration & Resources on the proposed Traffic Regulation Order – The Inverclyde Council, Disabled Persons’ Parking Places (On-Street) Order No. 1 2020 recommended that the Inverclyde Council be asked to make the Traffic Regulation Order and to remit it to the Shared Head of Service Roads and the Head of Legal and Property Services to arrange for its implementation.
- 2.2 The Policy & Resources Committee held on 24 March 2020 agreed that for the duration of the COVID-19 emergency Standing Orders and the Scheme of Administration be suspended and that all functions delegated to Committees be remitted to the Policy & Resources Executive Sub-Committee for the duration of the emergency.

## 3.0 RECOMMENDATION

- 3.1 That the Sub-Committee approves the making of the Traffic Regulation Order – The Inverclyde Council, Disabled Persons’ Parking Places (On-Street) Order No. 1 2020 and that the Shared Head of Service Roads and the Head of Legal and Property Services be authorised to take all necessary action in connection therewith.

Appendix  
1

**Gerard Malone**  
**Head of Legal and Property Services**

#### 4.0 BACKGROUND

- 4.1 Local Authorities are empowered to make Orders under the Road Traffic Regulation and Roads (Scotland) Act 1984.
- 4.2 The provision of on-street parking places for use by disabled drivers, who are the holders of a Disabled Person's Badge, is regulated by The Disabled Persons' Parking Places (Scotland) Act 2009. Inverclyde Council is required to promote a Traffic Regulation Order to regulate the use of such parking places.
- 4.3 The Sub-Committee is asked to note that, if approved, the Order may not be implemented until the making of the Order has been advertised to allow any persons who so wish a period of six weeks to question the validity of the Order in terms of the Road Traffic Regulation Act 1984.

#### 5.0 IMPLICATIONS

##### 5.1 Finance

###### Financial Implications:

###### One off Costs

Cost Centre	Budget Heading	Budget Years	Proposed Spend this Report	Virement From	Other Comments
N/A					

###### Annually Recurring Costs/ (Savings)

Cost Centre	Budget Heading	With Effect from	Annual Net Impact	Virement From (If Applicable)	Other Comments
N/A					

##### 5.2 Legal

There are no legal implications arising from this report.

##### 5.3 Human Resources

There are no HR implications arising from this report.

##### 5.4 Equalities

###### Equalities

- (a) Has an Equality Impact Assessment been carried out?

	YES (see attached appendix)
X	NO – This report does not introduce a new policy, function or strategy or recommend a substantive change to an existing policy, function or strategy. Therefore, no Equality Impact Assessment is required

- (b) Fairer Scotland Duty

If this report affects or proposes any major strategic decision:-

Has there been active consideration of how this report's recommendations reduce inequalities of outcome?

	YES – A written statement showing how this report's recommendations reduce inequalities of outcome caused by socio-economic disadvantage has been completed.
<b>X</b>	NO

(c) Data Protection

Has a Data Protection Impact Assessment been carried out?

	YES – This report involves data processing which may result in a high risk to the rights and freedoms of individuals.
<b>X</b>	NO

**5.5 Repopulation**

There are no repopulation implications arising from this report.

**6.0 CONSULTATIONS**

6.1 The proposals have been advertised in the Greenock Telegraph and full details of the proposals have been made available for public inspection during normal office hours at the offices of the Shared Head of Service Roads, the Customer Contact Centre and at Central, Port Glasgow, Southwest and Gourock Libraries.

**7.0 BACKGROUND PAPERS**

7.1 None

**THE INVERCLYDE COUNCIL**  
**DISABLED PERSONS' PARKING PLACES**  
**(ON-STREET) ORDER NO.1 2020**  
**TRAFFIC REGULATION ORDER**

**THE INVERCLYDE COUNCIL**  
**DISABLED PERSONS' PARKING PLACES (ON-STREET)**  
**ORDER NO.1 2020**

The Inverclyde Council in exercise of the powers conferred on them by Section 32(1) of the Road Traffic Regulation Act 1984 ("the Act") and of all other enabling powers and after consultation with the Chief Constable of Police Scotland in accordance with Part III of Schedule 9 to the Act hereby make the following Order.

1. This Order may be cited as "The Inverclyde Council Disabled Persons' Parking Places (On-Street) Order No. 1 2020" and shall come into operation on #####.

2. In this Order the following expressions have the meanings hereby assigned to them:-

"Council" means The Inverclyde Council or its successors as Roads Authority;

"disabled person's badge" means:

- (a) a badge issued under Section 21 of the Chronically Sick and Disabled Persons Act 1970 (as amended);
  - (b) a badge issued under a provision of the law of Northern Ireland corresponding to that section; or
  - (c) a badge issued by any member State other than the United Kingdom for purposes corresponding to the purposes for which badges under that section are issued;
- and which has not ceased to be in force;

"disabled person's vehicle" means a vehicle lawfully displaying a disabled person's badge;

"parking attendant" means a person employed in accordance with Section 63A of the Act to carry out the functions therein;

"parking place" means an area of land specified by number and name in Columns 1 and 2 in the Schedule to this Order;

"traffic sign" means a sign prescribed or authorised under Section 64 of the Act; and

"vehicle" unless the context otherwise requires, means a vehicle of any description and includes a machine or implement of any kind drawn or propelled along roads whether or not by mechanical power.

3. The Schedule titled "Disabled Persons' Parking Places (On Street) Order No. 1 2020" forms the Schedule to this Order.

4. Each area of road which is described in the Schedule Part 1 to this Order and the plans relative to this Order is hereby designated as a parking place.

5. The parking places shall only be used for the leaving of disabled persons' vehicles displaying a valid disabled person's badge.

6. The limits of each parking place shall be indicated on the carriageway as prescribed by The Traffic Signs Regulations and General Directions 2016, as amended.
7. Every vehicle left in any parking place shall stand such that no parking place is occupied by more than one vehicle and that every part of the vehicle is within the limits of the parking place provided that, where the length of a vehicle precludes compliance with this paragraph, such vehicle shall be deemed to be within the limits of a parking place if:-  
  
the extreme front portion or, as the case may be, the extreme rear portion of the vehicle is within 300mm of an indication on the carriageway provided under this Order in relation to the parking place; and  
  
the vehicle, or any part thereof, is not within the limits of any adjoining parking place.
8. Any person duly authorised by the Council or a police officer in uniform or a traffic warden or parking attendant may move or cause to be moved in case of any emergency, to any place they think fit, vehicles left in a parking place.
9. Any person duly authorised by the Council may suspend the use of a parking place or any part thereof whenever such suspension is considered reasonably necessary:-  
  
for the purpose of facilitating the movement of traffic or promoting its safety;  
  
for the purpose of any building operation, demolition, or excavation in or adjacent to the parking place or the laying, erection, alteration, removal or repair in or adjacent to the parking place of any sewer or of any main, pipe, apparatus for the supply of gas, water electricity or of any telecommunications apparatus, traffic sign or parking meter;  
  
for the convenience of occupiers of premises adjacent to the parking place on any occasion of the removal of furniture from one office or dwellinghouse to another or the removal of furniture from such premises to a depository or to such premises from a depository;  
  
on any occasion on which it is likely by reason of some special attraction that any street will be thronged or obstructed; or  
  
for the convenience of occupiers of premises adjacent to the parking place at times of weddings or funerals or on other special occasions.
10. A police officer in uniform may suspend for not longer than twenty four hours the use of a parking place or part thereof whenever such suspension is considered reasonably necessary for the purpose of facilitating the movement of traffic or promoting its safety.

11. This Order insofar as it relates to the parking places to be revoked (R) and amended, as specified in the Schedule Part 2 to this Order, partially revokes and amends The Inverclyde Council Disabled Persons' Parking Places (On-Street) Order Nos. 02/2009, 04/2010, 04/2011, 04/2013, 01/2016, 04/2015 and 02/2017 respectively.

Sealed with the Common Seal of The Inverclyde Council and subscribed for them and on their behalf by #####, Proper Officer, on the ##### day of #####, Two Thousand and #####.

DRAFT







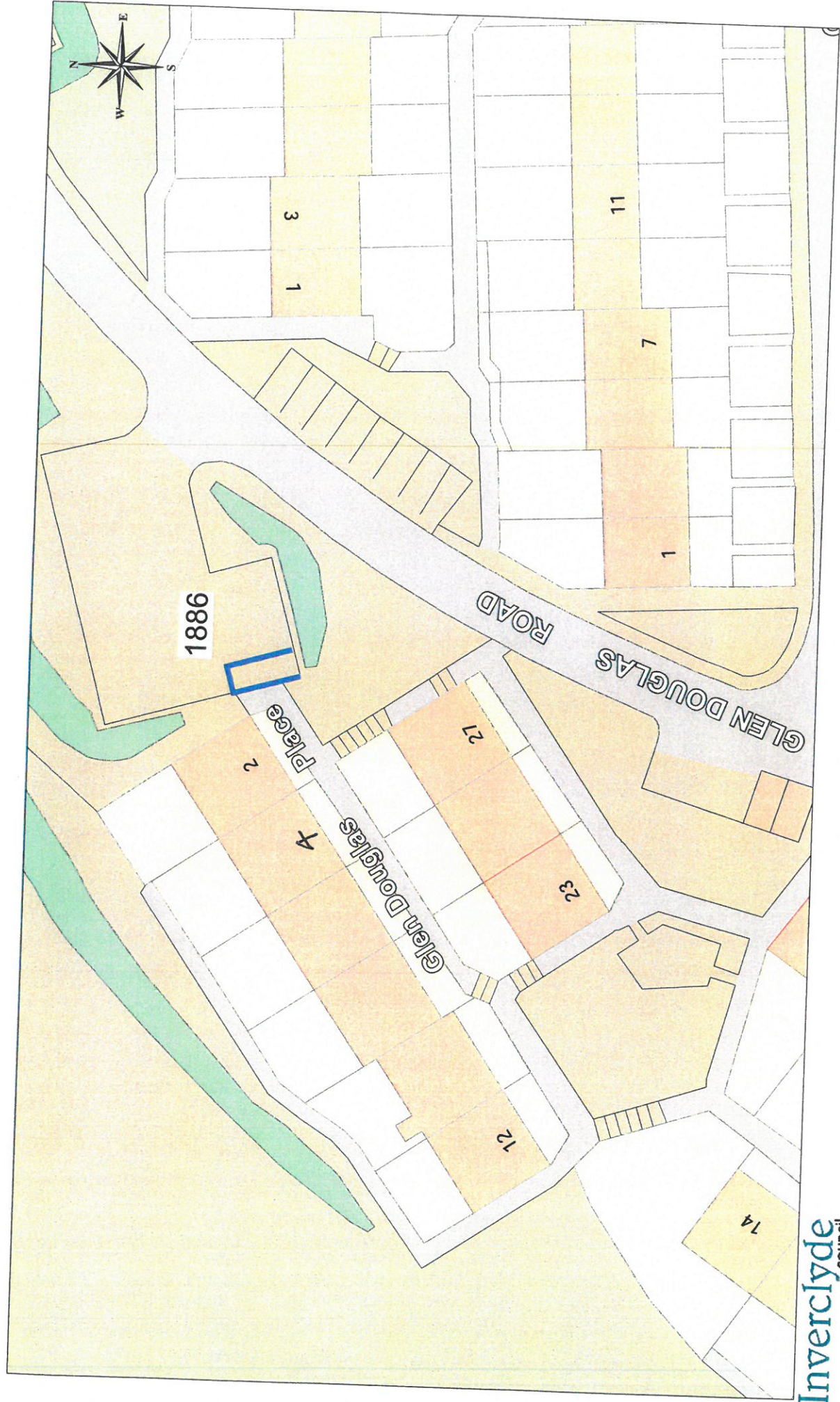

Reproduced by permission of Ordnance Survey on behalf of HMISO.  
 ©Crown copyright and database right 2019.  
 All rights reserved.

**DISABLED PERSONS' PARKING PLACE**  
**4 GLEN DOUGLAS PLACE, GREENOCK**  
**PLACE No. 1886**

**Inverclyde**  
 council

**Roads & Transportation**

Environment, Regeneration & Resources  
 Corporate Director: Scott Allan BSc., C.Eng., M.I.C.E.

Municipal Buildings  
 Clyde Square  
 Greenock, PA15 1LY  
 Tel: 01475 712712  
 Fax: 01475 712731  
 scott.allan@inverclyde.gov.uk



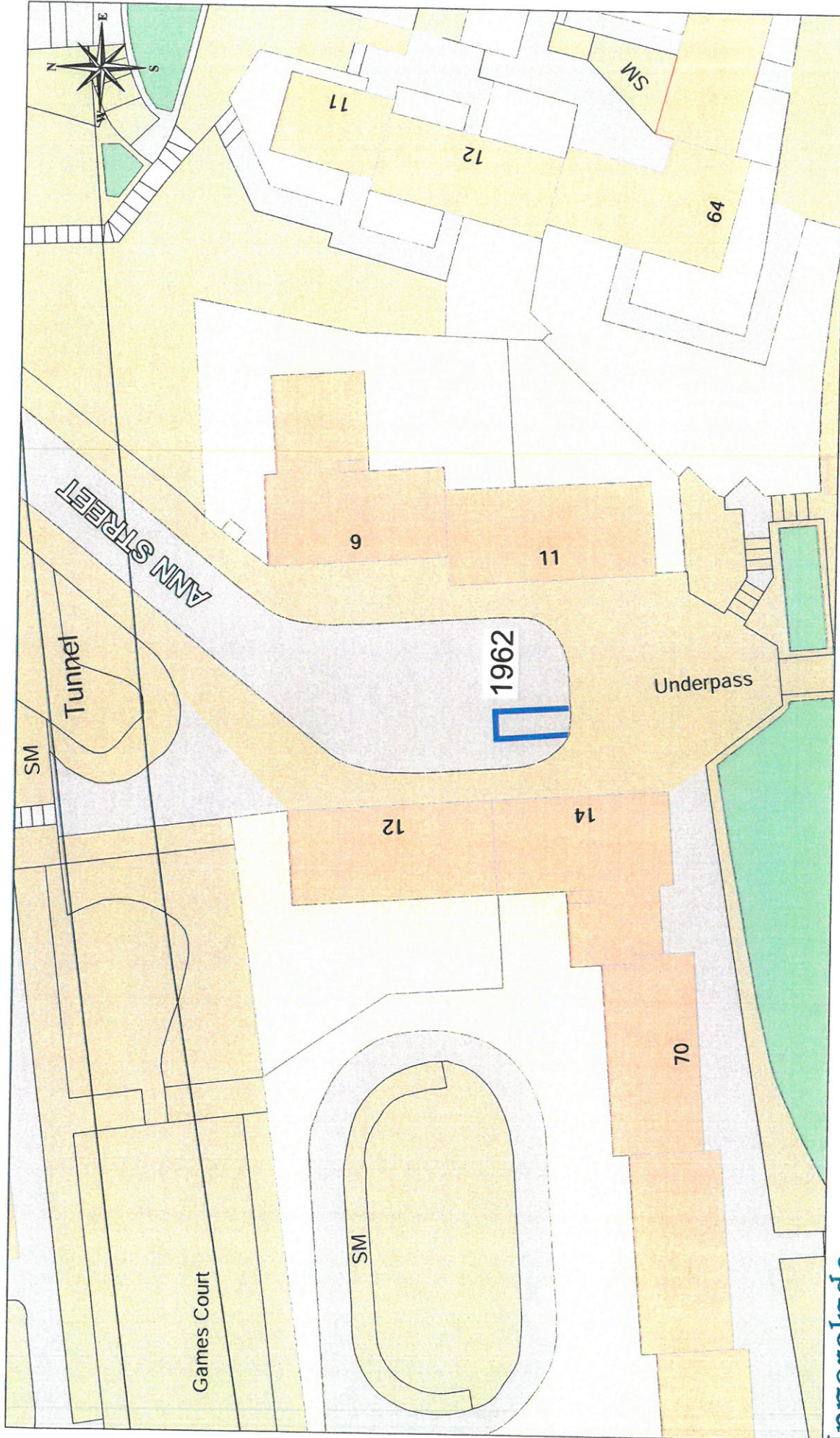

Reproduced by permission of Ordnance Survey on behalf of HMSO.  
 ©Crown copyright and database right 2019.  
 All rights reserved.  
 Ordnance Survey Licence number 10023421.

**Inverclyde**  
 council  
**Roads & Transportation**  
 Environment, Regeneration & Resources  
 Corporate Director: Scott Allan BSc., C.Eng., M.I.C.E.  
 Municipal Buildings  
 Clyde Square  
 Greenock, PA15 1LY  
 Tel: 01475 712712  
 Fax: 01475 712731  
 scott.allan@inverclyde.gov.uk

**DISABLED PERSONS' PARKING PLACE**  
**14 ANN STREET, GREENOCK**  
**PLACE No. 1962**



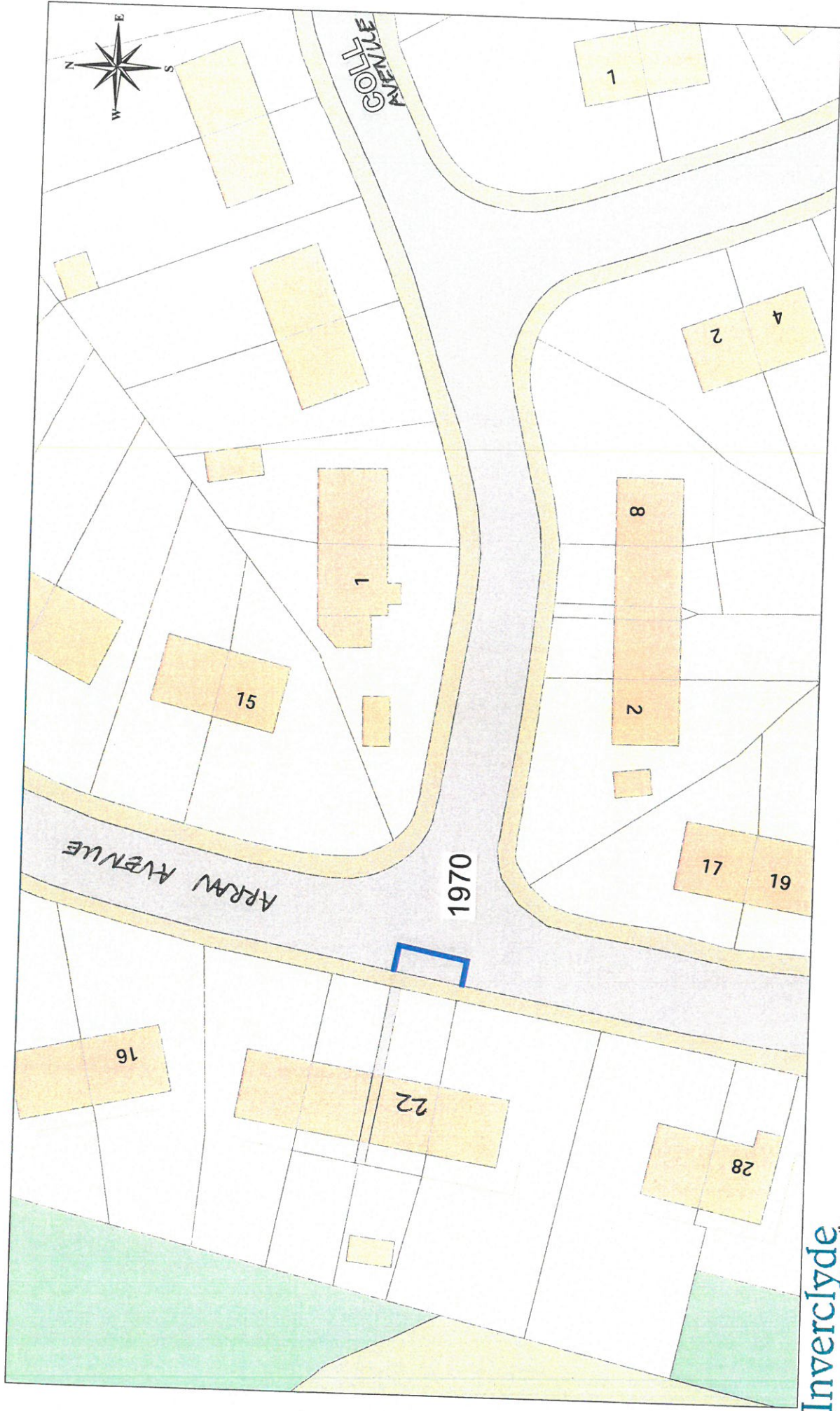

Reproduced by permission of Ordnance Survey on behalf of HMSO.  
 ©Crown copyright and database right 2019.  
 All rights reserved.

**DISABLED PERSONS' PARKING PLACE**  
**22 ARRAN AVENUE, PORT GLASGOW**  
**PLACE No. 1970**

**Inverclyde council**  
**Roads & Transportation**  
 Environment, Regeneration & Resources  
 Corporate Director: Scott Allan BSc., C.Eng., M.I.C.E.  
 Municipal Buildings  
 Clyde Square  
 Greenock, PA15 1LY  
 Tel: 01475 712712  
 Fax: 01475 712731  
 scott.allan@inverclyde.gov.uk



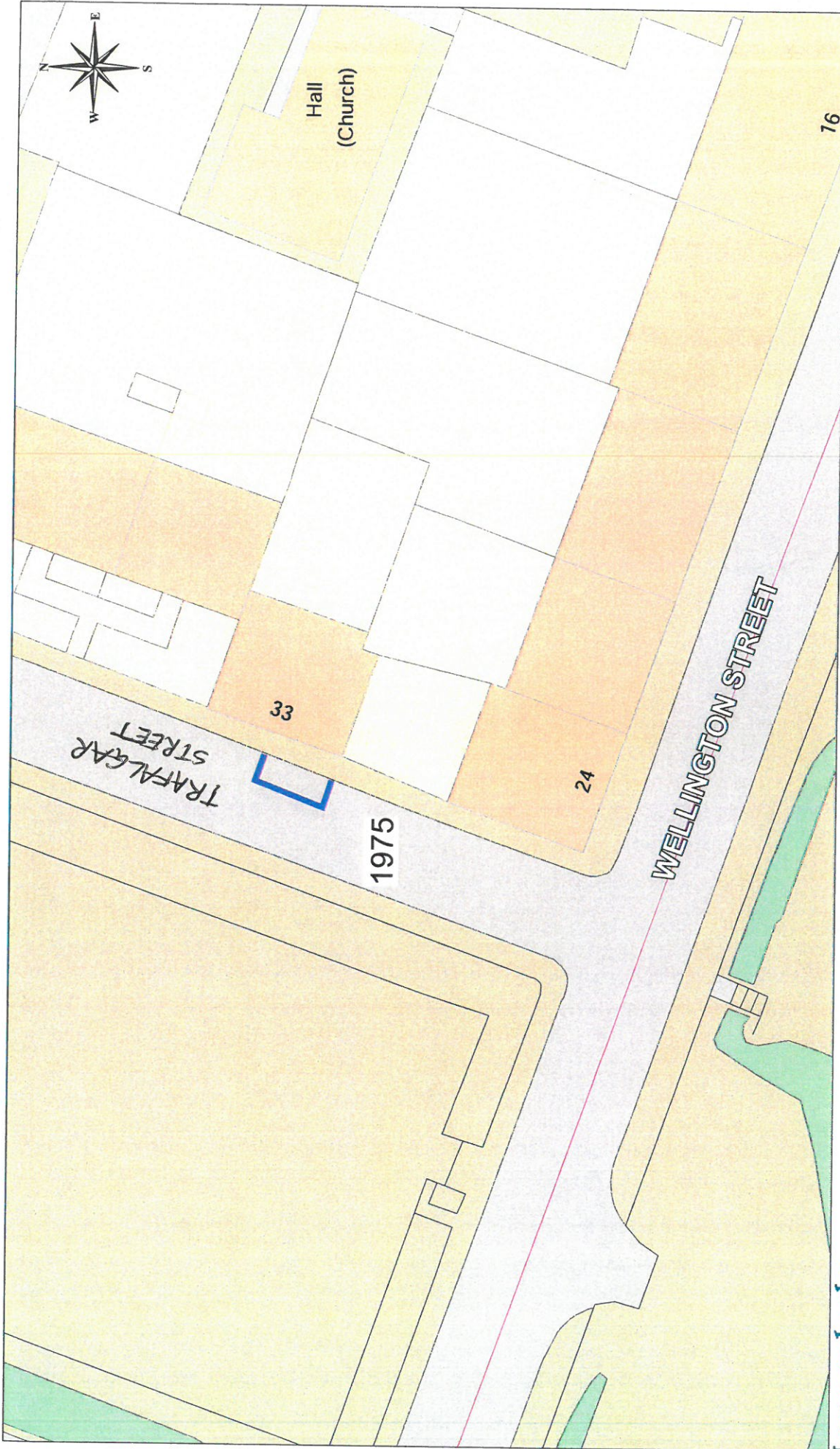

Reproduced by permission of Ordnance Survey on behalf of HMSO.  
 ©Crown copyright and database right 2019.  
 All rights reserved.  
 Ordnance Survey Licence number 10023421.

**Inverclyde** council  
**Roads & Transportation**  
 Environment, Regeneration & Resources  
 Corporate Director: Scott Allan BSc., C.Eng., M.I.C.E.  
 Municipal Buildings  
 Clyde Square  
 Greenock, PA15 1LY  
 Tel: 01475 712712  
 Fax: 01475 712731  
 scott.allan@inverclyde.gov.uk

**DISABLED PERSONS' PARKING PLACE**  
**33 TRAFALGAR STREET, GREENOCK**  
**PLACE No. 1975**





Reproduced by permission of Ordnance Survey on behalf of HMSO.  
 © Crown copyright and database right 2010.  
 All rights reserved.  
 Ordnance Survey Licence number 10023421.

**DISABLED PERSONS' PARKING PLACE**  
**11 FORSYTH STREET, GREENOCK**  
**PLACE No. 1976**

**Inverclyde council**  
**Roads & Transportation**  
 Environment, Regeneration & Resources  
 Corporate Director: Scott Allan BSc., C.Eng., M.I.C.E.  
 Municipal Buildings  
 Clyde Square  
 Greenock, PA15 1LY  
 Tel: 01475 71272  
 Fax: 01475 71273  
 scott.allan@inverclyde.gov.uk



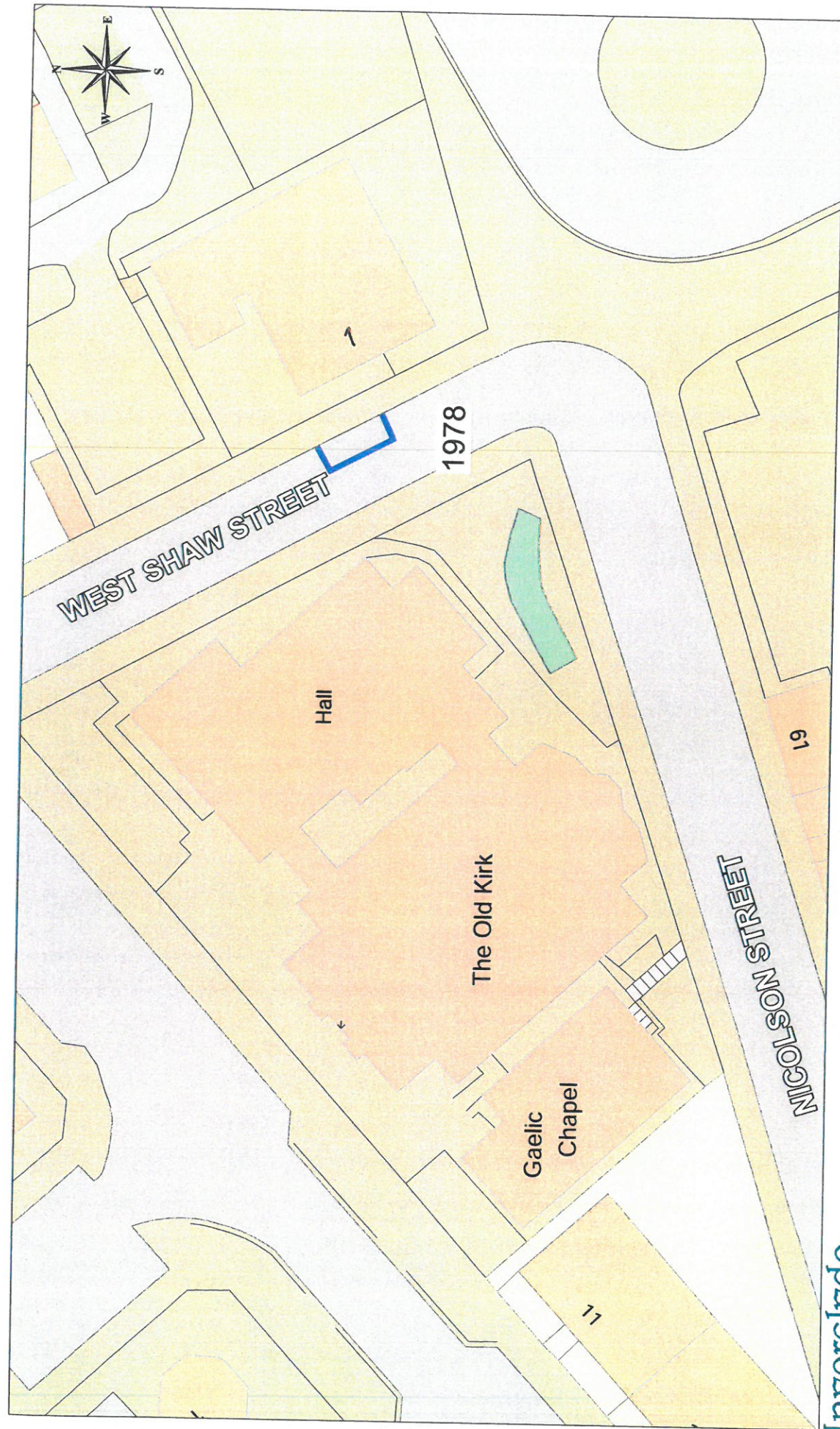
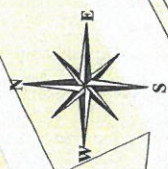

Reproduced by permission of Ordnance Survey on behalf of HMSO.  
©Crown copyright and database right 2019.  
All rights reserved.  
Ordnance Survey Licence number 10023421.

**Inverclyde**  
council

Roads & Transportation

Environment, Regeneration & Resources  
Corporate Director: Scott Allan BSc., C.Eng., M.I.C.E.  
Municipal Buildings  
Clyde Square  
Greenock, PA15 1LY  
Tel: 01475 712712  
Fax: 01475 712731  
scott.allan@inverclyde.gov.uk

DISABLED PERSONS' PARKING PLACE  
1 WEST SHAW STREET, GREENOCK  
PLACE No. 1978



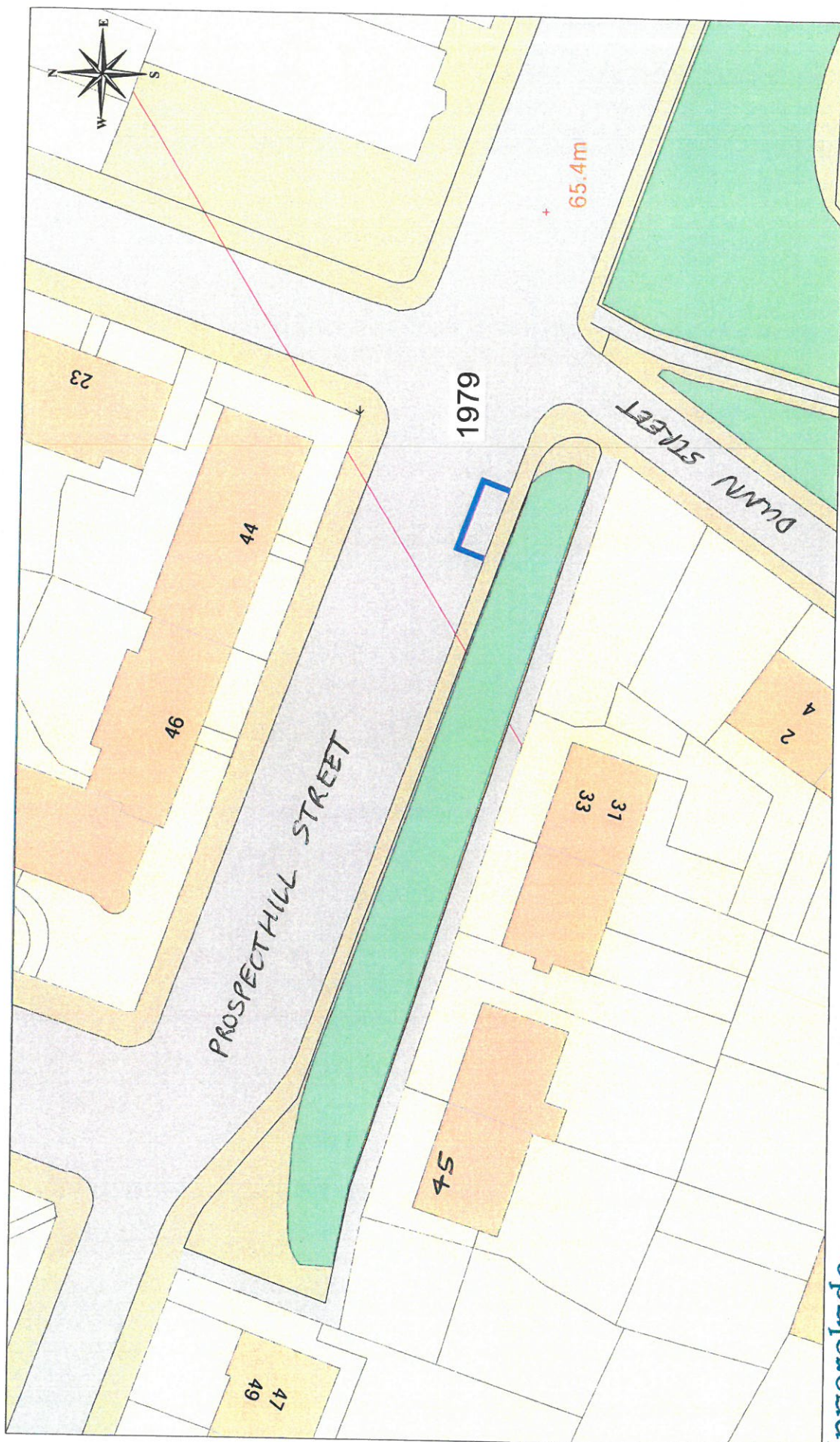

Reproduced by permission of Ordnance Survey on behalf of HMSO.  
 ©Crown copyright and database right 2019.  
 All rights reserved.  
 Ordnance Survey Licence number 10023421.

**Inverclyde**  
 council  
 Roads & Transportation

Environment, Regeneration & Resources  
 Corporate Director: Scott Allan BSc., C.Eng., M.I.C.E.  
 Municipal Buildings  
 Clyde Square  
 Greenock, PA15 1LY  
 Tel: 01475 712712  
 Fax: 01475 712731  
 scott.allan@inverclyde.gov.uk

DISABLED PERSONS' PARKING PLACE  
 45 PROSPECT HILL STREET, GREENOCK  
 PLACE No. 1979



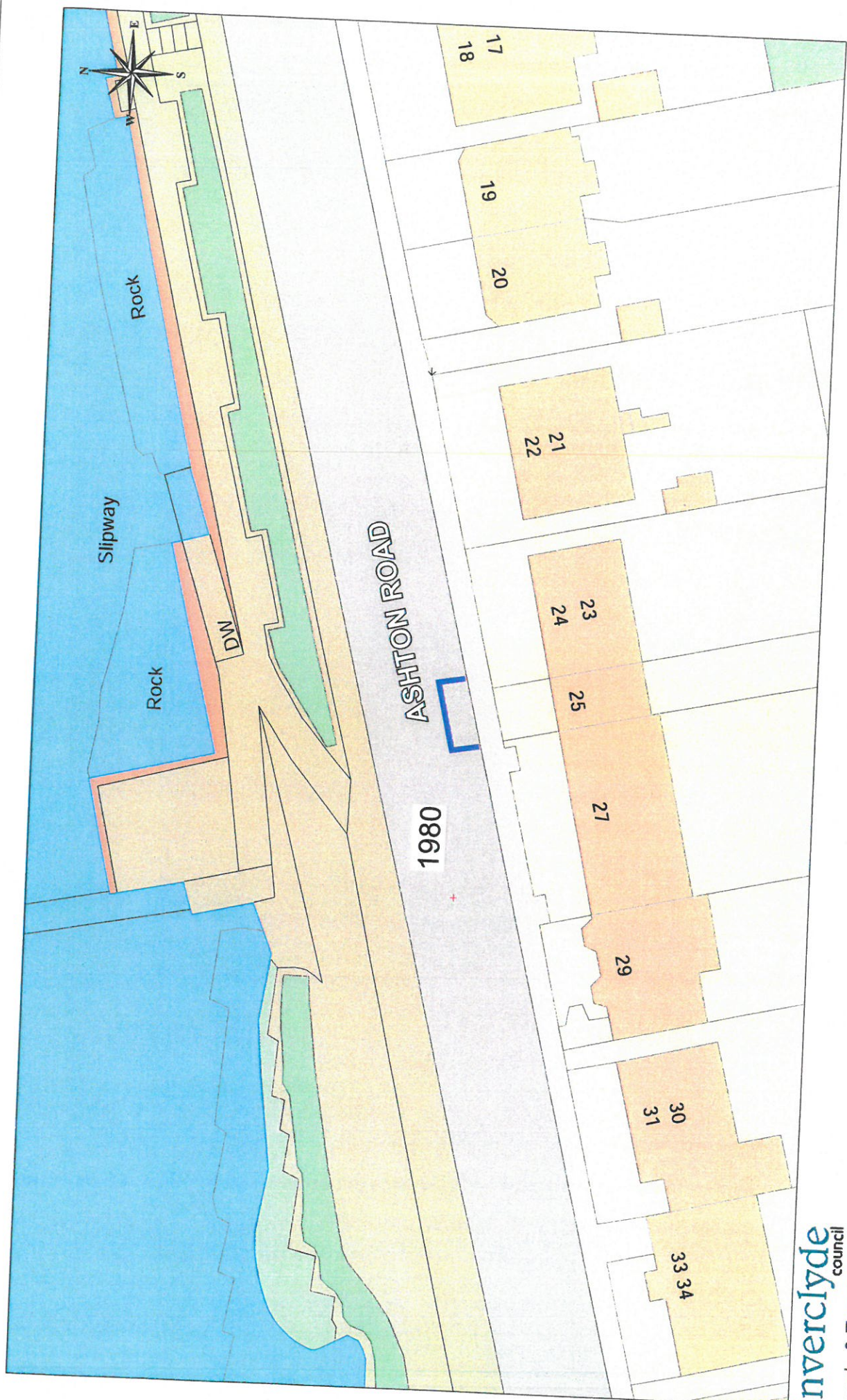

Reproduced by permission of Ordnance Survey on behalf of HMSO.  
 ©Crown copyright and database right 2019.  
 All rights reserved.

DISABLED PERSONS' PARKING PLACE  
 25 ASHTON ROAD, GOUROCK  
 PLACE No. 1980

**Inverclyde** council  
 Roads & Transportation  
 Environment, Regeneration & Resources  
 Corporate Director: Scott Allan BSc., C.Eng., M.I.C.E.  
 Municipal Buildings  
 Clyde Square  
 Greenock, PA15 1LY  
 Tel: 01475 712742  
 Fax: 01475 712731  
 scott.allan@inverclyde.gov.uk





LINNET ROAD

13

24

14 12

1981

MAVIS ROAD

23

13 15

17



Reproduced by permission of Ordnance Survey on behalf of HMSO.  
©Crown copyright and database right 2019.  
All rights reserved.  
Ordnance Survey Licence number 10023421.

DISABLED PERSONS' PARKING PLACE  
14 MAVIS ROAD, GREENOCK  
PLACE No. 1981

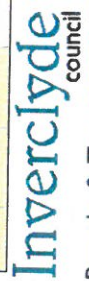

Roads & Transportation

Environment, Regeneration & Resources  
Corporate Director: Scott Allan BSc., C.Eng., M.I.C.E.  
Municipal Buildings  
Clyde Square  
Greenock, PA15 1LY  
Tel: 01475 712712  
Fax: 01475 712731  
scott.allan@inverclyde.gov.uk



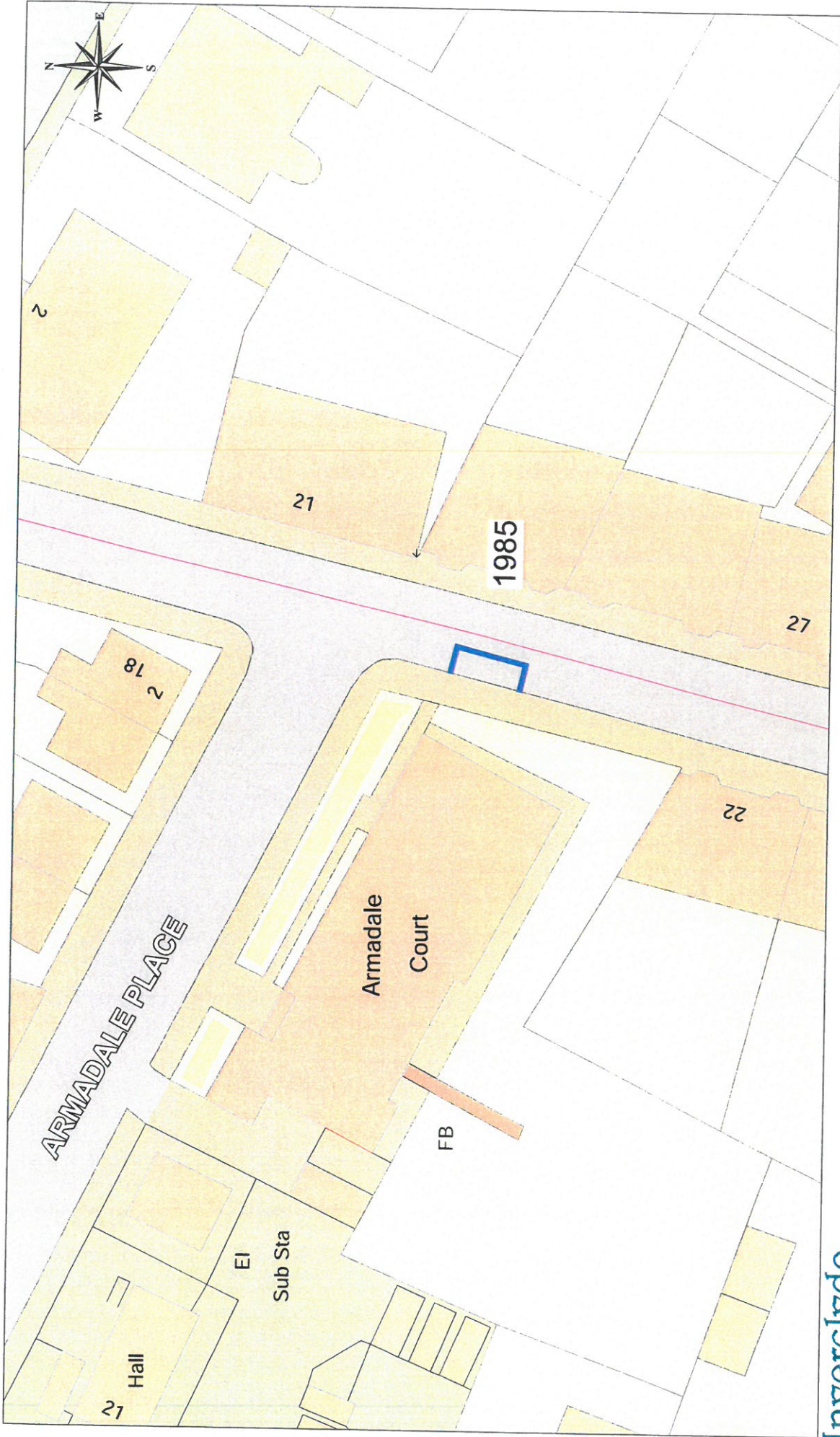

Reproduced by permission of Ordnance Survey on behalf of HMSO.  
 ©Crown copyright and database right 2019.  
 All rights reserved.  
 Ordnance Survey Licence number 10023421.

**Inverclyde**  
 council

Roads & Transportation

Environment, Regeneration & Resources  
 Corporate Director: Scott Allan BSc., C.Eng., M.I.C.E.  
 Municipal Buildings  
 Clyde Square  
 Greenock, PA15 1LY  
 Tel: 01475 712712  
 Fax: 01475 712731  
 scott.allan@inverclyde.gov.uk

DISABLED PERSONS' PARKING PLACE  
 BANK STREET, GREENOCK  
 PLACE No. 1985



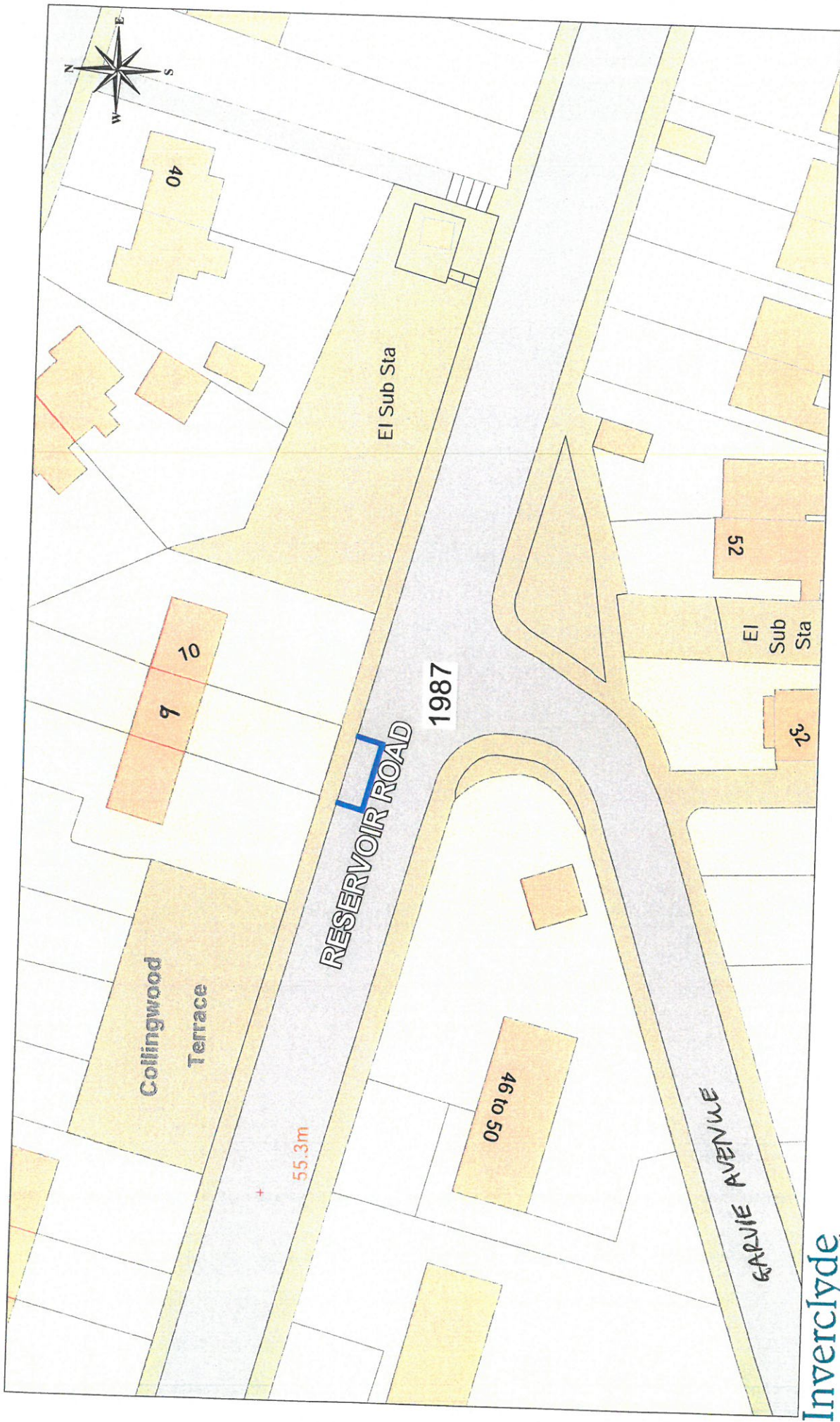

Reproduced by permission of Ordnance Survey on behalf of HMSO.  
 ©Crown copyright and database right 2019.  
 All rights reserved.

**Inverclyde**  
 council

Roads & Transportation

Environment, Regeneration & Resources  
 Corporate Director: Scott Allan BSc., C.Eng., M.I.C.E.  
 Municipal Buildings  
 Clyde Square  
 Greenock, PA15 1LY  
 Tel: 01475 712712  
 Fax: 01475 712731  
 scott.allan@inverclyde.gov.uk

DISABLED PERSONS' PARKING PLACE  
 9 COLLINGWOOD TERRACE, GOUROCK  
 PLACE No. 1987



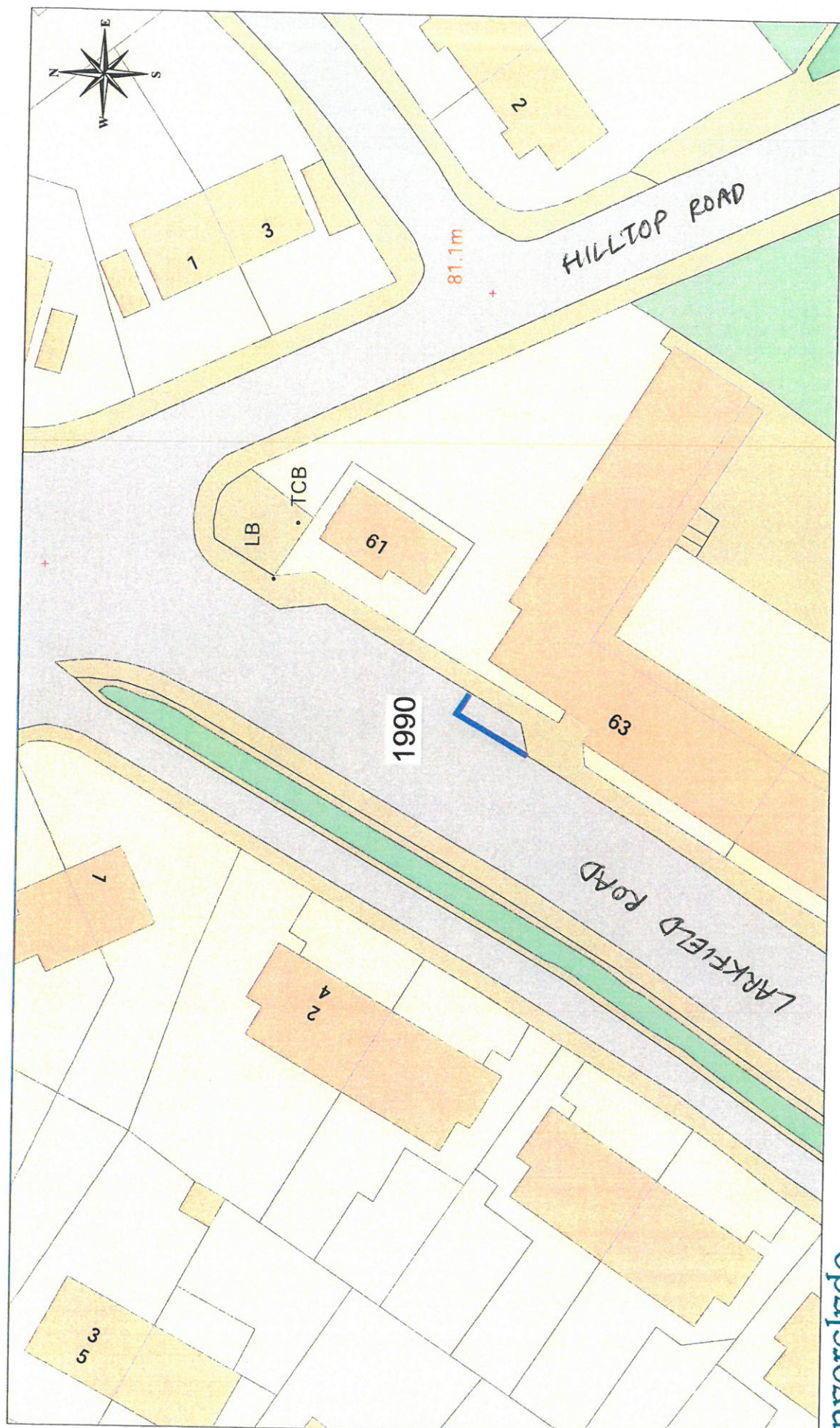

Reproduced by permission of Ordnance Survey on behalf of HMISO.  
 ©Crown copyright and database right 2019.  
 All rights reserved.  
 Ordnance Survey Licence number 10023421.

**Inverclyde**  
 council  
 Roads & Transportation

Environment, Regeneration & Resources  
 Corporate Director: Scott Allan BSc., C. Eng., M.I.C.E.  
 Municipal Buildings  
 Clydeside Square, PA15 1LY  
 Glasgow, G5 1LJ  
 Tel: 01475 712712  
 Fax: 01475 712731  
 scott.allan@inverclyde.gov.uk

DISABLED PERSONS' PARKING PLACE  
 63 LARKFIELD ROAD, GOUROCK  
 PLACE No. 1990



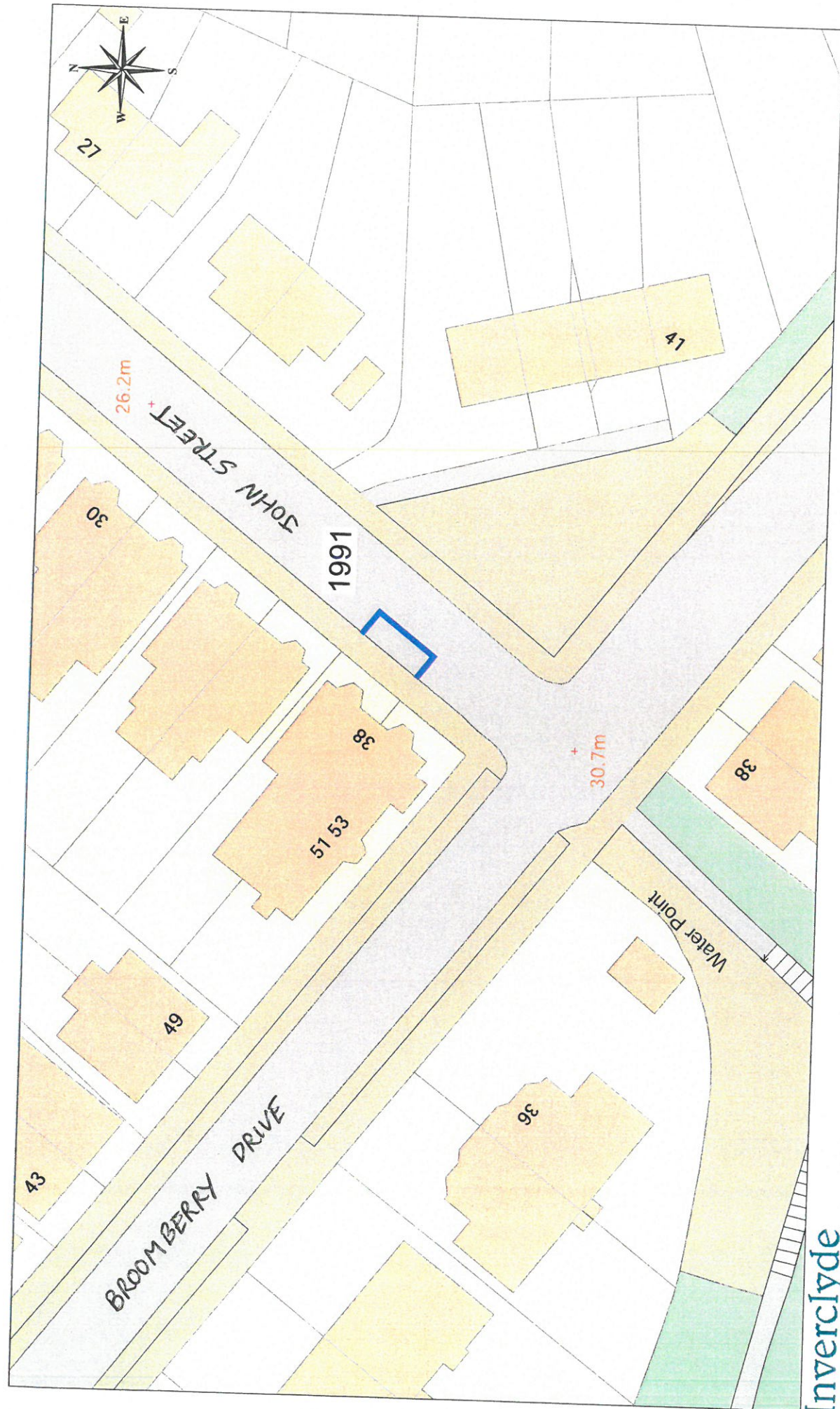

Reproduced by permission of Ordnance Survey on behalf of HMSO.  
 ©Crown copyright and database right 2019.  
 All rights reserved.

**Inverclyde**  
 council

Roads & Transportation

Environment, Regeneration & Resources  
 Corporate Director: Scott Allan BSc., C.Eng., M.I.C.E.  
 Municipal Buildings  
 Clyde Square  
 Greenock, PA15 1LY  
 Tel: 01475 712712  
 Fax: 01475 712731  
 scott.allan@inverclyde.gov.uk

DISABLED PERSONS' PARKING PLACE  
 38 JOHN STREET, GOUROCK  
 PLACE No. 1991



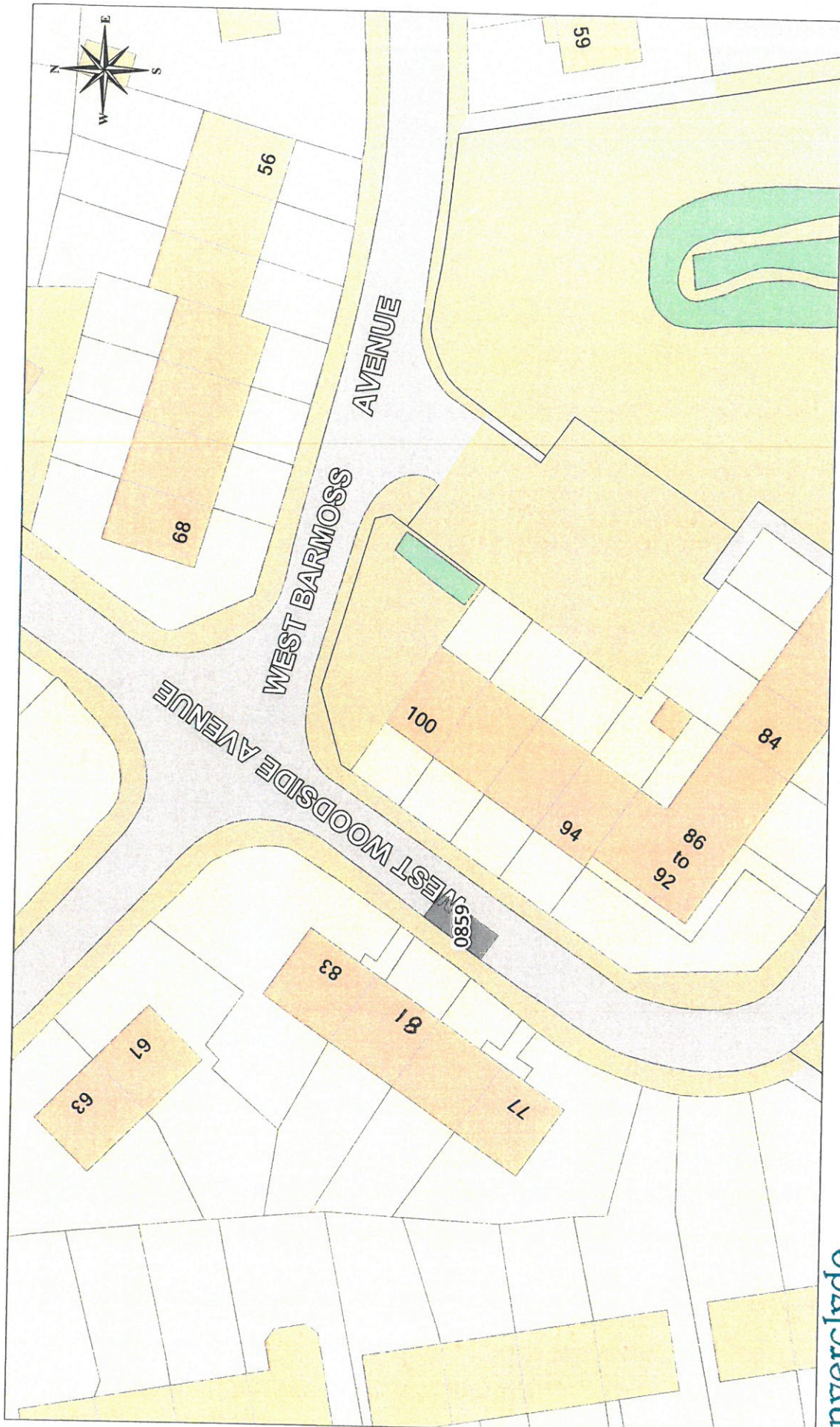

Reproduced by permission of Ordnance Survey on behalf of HMISO.  
 ©Crown copyright and database right 2019.  
 All rights reserved.  
 Ordnance Survey Licence number 10023421.

**Inverclyde**  
 council  
 Roads & Transportation

Environment, Regeneration & Resources  
 Corporate Director: Scott Allan BSc., C.Eng., M.I.C.E.  
 Municipal Buildings  
 Clyde Square  
 Greenock, PA15 1LY  
 Tel: 01475 712712  
 Fax: 01475 712731  
 scott.allan@inverclyde.gov.uk

**DISABLED PERSONS' PARKING PLACE**  
**81 WEST WOODSIDE AVE, PORT GLASGOW**  
**PLACE No. 0859 REVOCATION**



Disabled Bays HEAD OF SERVICE ALAN G BARNES MCIWM CEMV	Scale : 1:500		Date : JULY 2010
	Prepared by : R. MACKAY		Checked by :
71 EAST HAMILTON STREET GREENOCK, PA15 2UA	Drawing No. :		Approved by :
	Licence No. LA03097L		File No. : 19/12
Disabled Persons' Parking Place 54 Broadfield Avenue, Port Glasgow Place No. 1032 Revocation			
Reproduced from Ordnance Survey mapping with the permission of the Controller of Her Majesty's Stationery Office. Crown Copyright. No reproduction in any form is permitted without the prior written permission of Ordnance Survey. Any reproduction in any form without the prior written permission of Ordnance Survey is prohibited and may result in prosecution or legal proceedings.			
Licence No. LA03097L			



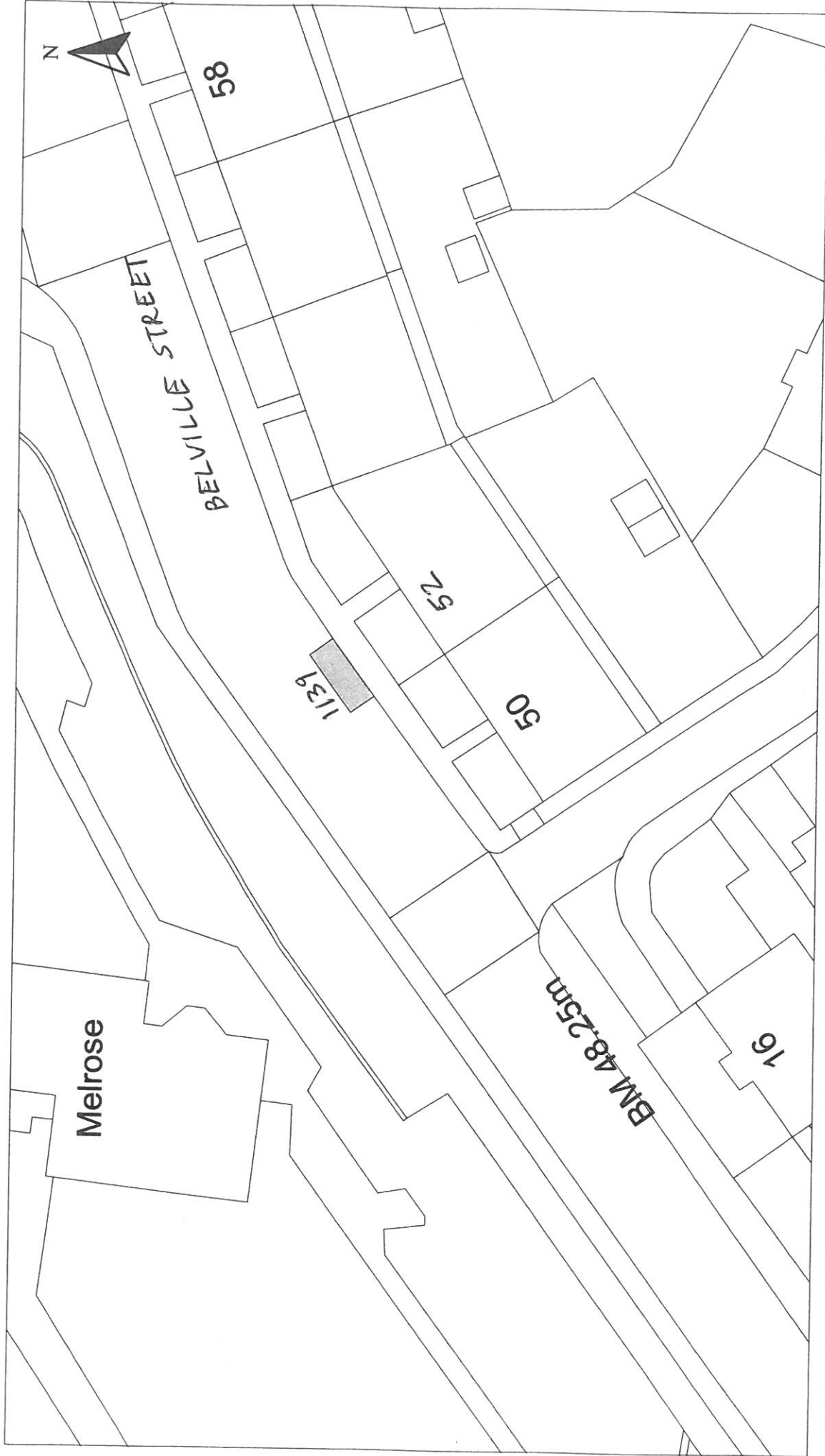

Disabled Bays HEAD OF SERVICE IAN MOFFAT 71 EAST HAMILTON STREET GREENOCK, PA15 2UA	Scale : 1:500 Prepared by : R. MACKAY Drawn by : R. MACKAY Drawing No. :		Date : AUG 2011 Checked by : Approved by : File No. : 19/12
	DISABLED PERSONS' PARKING PLACE 52 BELVILLE STREET, GREENOCK PLACE No. 1139 REVOCATION		
Reproduced from Ordnance Survey mapping with the permission of the Controller of Her Majesty's Stationery Office. Crown Copyright. Unauthorised reproduction infringes Crown Copyright and may result in prosecution or legal proceedings.		Licence No. LA03097L  Ordnance Survey	

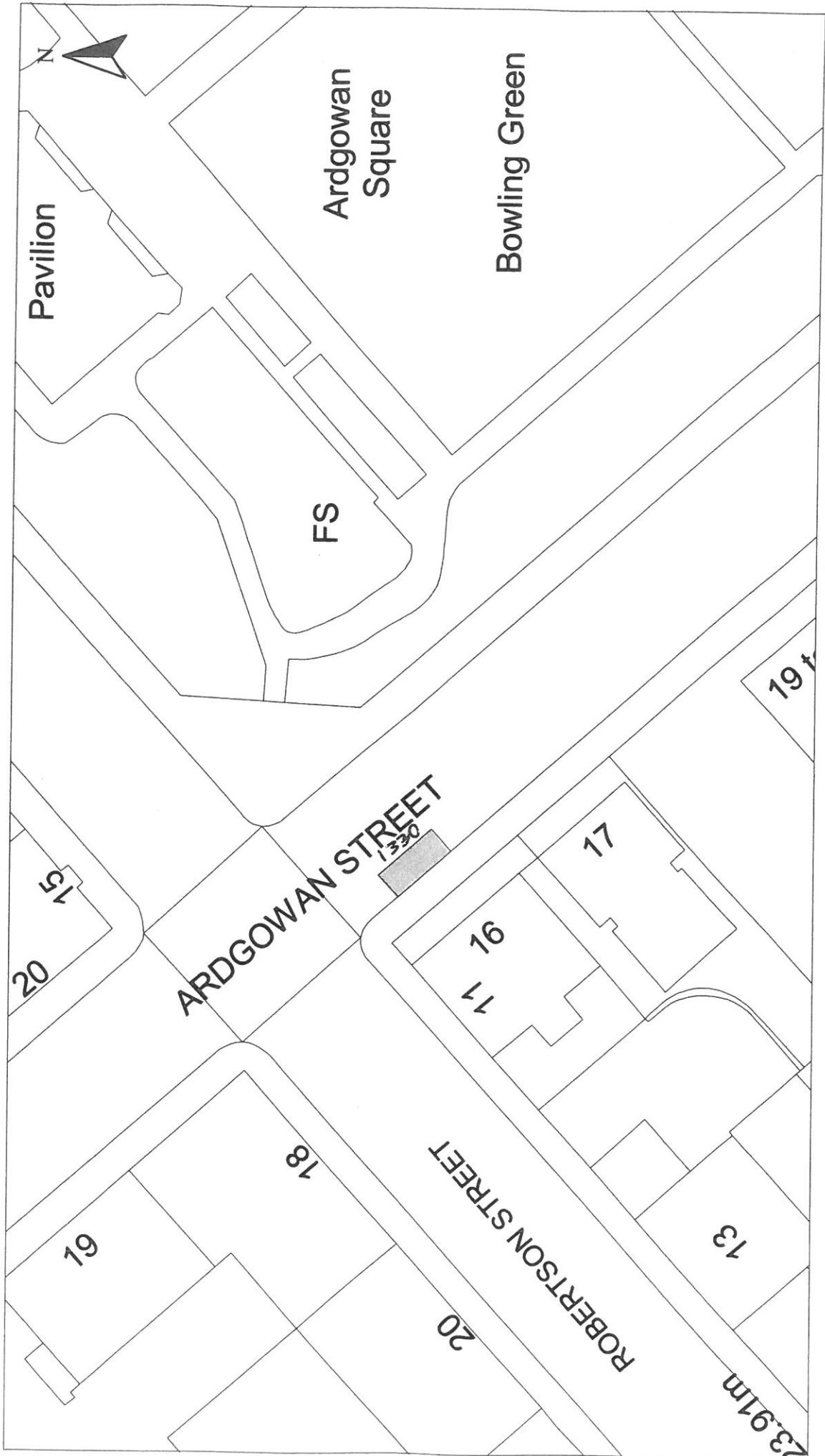

Disabled Bays	HEAD OF SERVICE IAN MOFFAT	Reproduced from Ordnance Survey mapping with the permission of the Controller of Her Majesty's Stationery Office. Crown Copyright. Unauthorised reproduction infringes Crown Copyright and may result in prosecution or legal proceedings. Licence No. LA03097L 	Scale : 1:500	Date : JULY 2013
	71 EAST HAMILTON STREET GREENOCK, PA15 2UA		DISABLED PERSONS' PARKING PLACE 16 ARDGOWAN SQUARE, GREENOCK PLACE No. 1330 REVOCATION	Prepared by : R. MACKAY Drawn by : R. MACKAY Drawing No. : 19/12



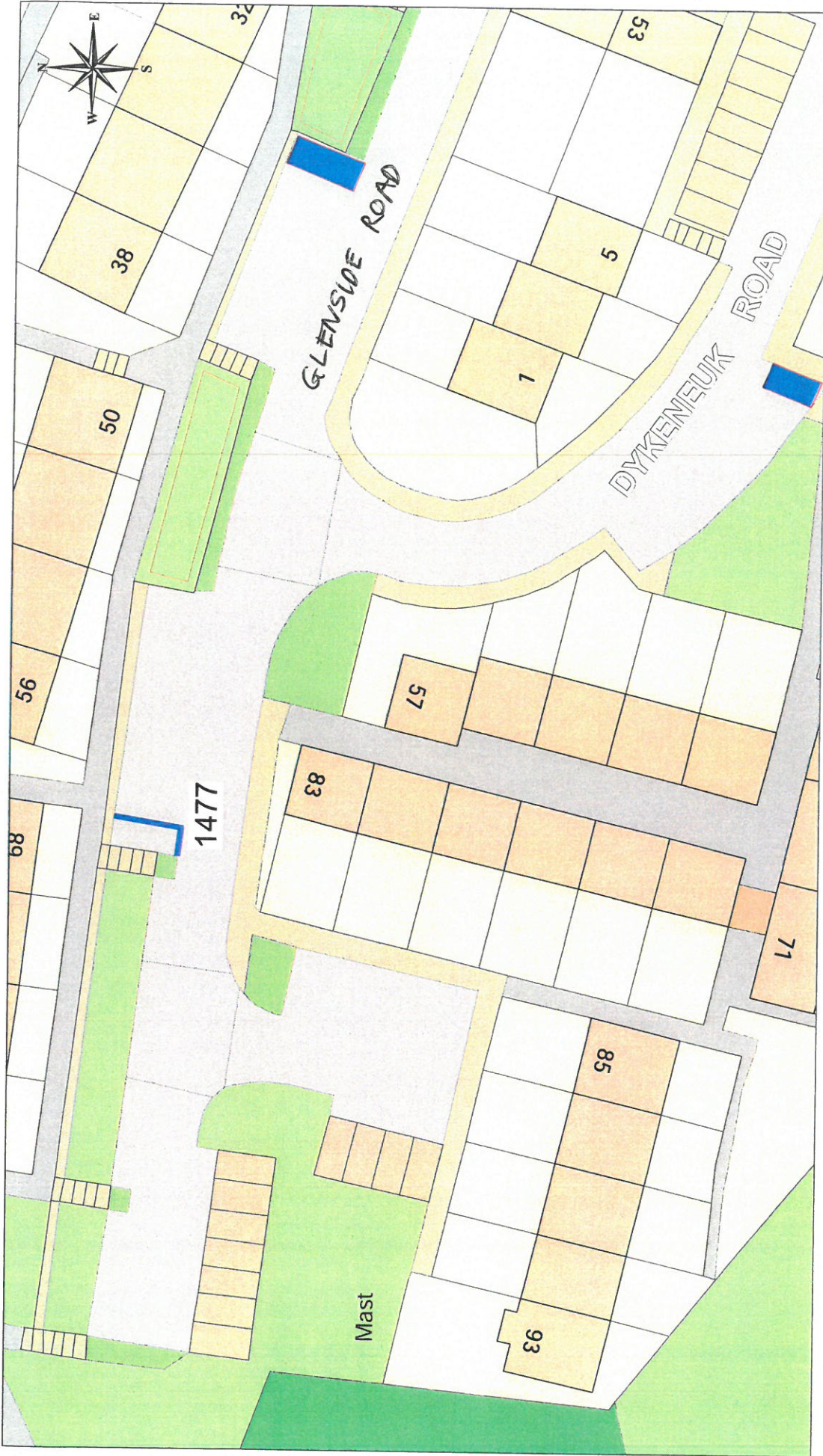

 Licensed System Supplier  
 This material has been reproduced from  
 Ordnance Survey maps, data with  
 the permission of the Controller of  
 Her Majesty's Stationery Office.  
 © Crown copyright.  
 Licence Number: 100029421

**DISABLED PERSONS' PARKING PLACE**  
**56 GLENSIDE ROAD, PORT GLASGOW**  
**PLACE No. 1477 REVOCATION**

**Inverclyde**  
 council  
**Environmental Services**  
 Regeneration & Environment  
 Corporate Director: Aubrey Fawcett  
 Municipal Buildings  
 Clyde Square  
 Greenock  
 PA15 1LY  
 Tel: 01475 712712  
 Fax: 01475 712731  
 aubrey.fawcett@inverclyde.gov.uk





DISABLED PERSONS' PARKING PLACE  
 60 NELSON ROAD, GOUROCK  
 PLACE No. 1541 REVOCATION



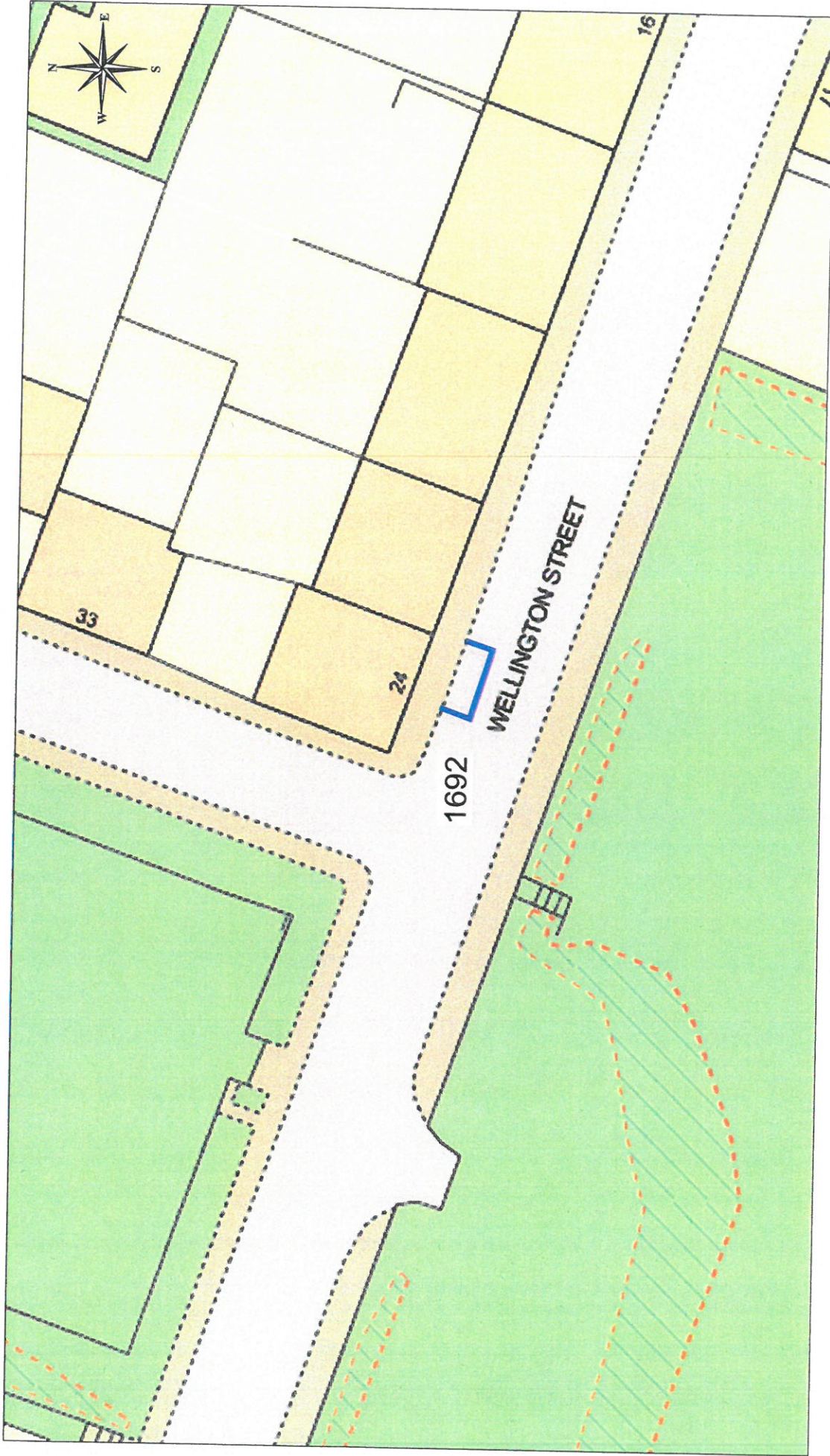

 Ordnance Survey  
 Licensed System Supplier  
This material has been reproduced from Ordnance Survey digital map data with the permission of Ordnance Survey on behalf of Her Majesty's Stationery Office. © Crown Copyright. Licence Number: 10003421

**DISABLED PERSONS' PARKING PLACE**  
**24B WELLINGTON STREET, GREENOCK**  
**PLACE No. 1692 REVOCATION**

**Inverclyde** council  
**Environmental Services**

Regeneration & Environment  
 Corporate Director: Aubrey Fawcett  
 Municipal Buildings  
 Clyde Square  
 Greenock  
 PA15 1LY  
 Tel: 01475 712712  
 Fax: 01475 712731  
[aubrey.fawcett@inverclyde.gov.uk](mailto:aubrey.fawcett@inverclyde.gov.uk)

**THE INVERCLYDE COUNCIL**

**DISABLED PERSONS' PARKING PLACES  
(ON-STREET) ORDER No. 1 2020**

**Statement of Reasons for Proposing to Make  
the above Order**

It is considered necessary, in order to comply with Section 5 of The Disabled Persons' Parking Places (Scotland) Act 2009, to make the above Order to provide assistance for disabled persons who hold a badge under the Disabled Persons (Badges for Motor Vehicles) (Scotland) Regulations 2000 as amended and to revoke those parking places no longer required to maximise street parking capacity.

Gail MacFarlane  
Shared Head of Service Roads  
8 Pottery Street  
GREENOCK  
PA15 2UH